

SEC 20 Simulator CSM 200

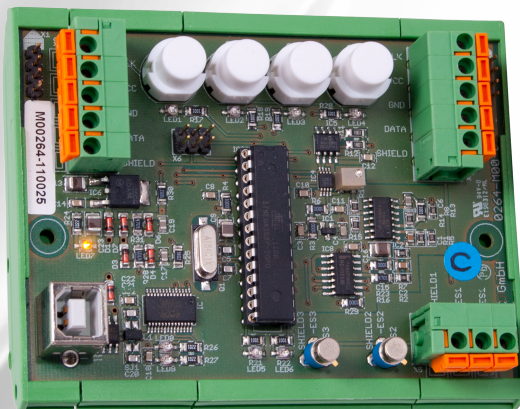

Features

- ▶ Designed to simulate sensor cable **SEC 20** in test set-ups
- ▶ Simulation of up to **200** sensors
- ▶ Two temperature sensors available on-board for manual heat-up or cool-down tests
- ▶ Additional facilities to connect up to two sensor cables **SEC 20** and an external temperature sensor **ESA-A5**
- ▶ Four push buttons, configurable with alternative temperature values, to simulate maximum temperature, differential temperature and differential temperature pre-alarms, as well as sensor loss.
- ▶ Test set-ups with redundant LIST systems can be realised by using two or more **CSM 200**
- ▶ 35 mm DIN-rail mount

Specifications

- ▶ Operating temperature: 0 °C ... +40 °C
- ▶ Dimensions: 102,5 x 82,0 x 42,0 mm (w x h x d, for 35 mm DIN-rail mount)
- ▶ Weight: 0,13 kg
- ▶ Number of sensors: Up to 200 (contiguous address range)
- ▶ Sensor address range: 0 ... 999
- ▶ Power supply: During operation by LISTcontroller via connection cable **VK SEC**, during set-up by **PC** via **USB-cable**
- ▶ Storage Conditions: 0 °C ... +60 °C, 30% ... 70% relative humidity, non condensing, prevention against shock, vibration, dust, electrostatic discharge **ESD**, **UV** light

Ordering Information

- ▶ **SEC 20 Simulator CSM 200** Art.-no.: **G00264**

Scope of Delivery

- ▶ **CSM 200** (pre-programmed with LISTEC default set-up)
- ▶ **USB-cable**, type **A-B**
- ▶ LISTmemory **USB** flash drive, including software and documentation

Application Software

- System prerequisites: **PC with Windows 10, 64-Bit and installed 64-Bit JavaRuntimeEnvironment**

Cable Simulation Module CSM 200

File Help

Connect Disconnect Refresh List Sensors Start Addr Clear RAM Save EEPROM Load EEPROM Save as File

Sensor ID	Start Address	End Address	Type	Temperature	Alternative Temperature
0	1	24	Memory	25.0	
1	25	25	Sensor ES3		
2	26	49	Memory	25.0	
3	50	90	Button S1	25.0	27.0
4	91	74	Memory	25.0	
5	75	75	Button S2	25.0	30.0
6	76	99	Memory	25.0	
7	100	100	Button S3	25.0	60.0
8	101	124	Memory	25.0	
9	125	125	Sensor ES2		
10	126	148	Memory	25.0	
11	150	150	Button S4	25.0	-27.0
12	151	199	Memory	-10.0	

Alternative Temperature

Push-Button	Alternative Temperature (°C)
Button S1	27.0
Button S2	30.0
Button S3	60.0
Button S4	-27.0

Dimensions

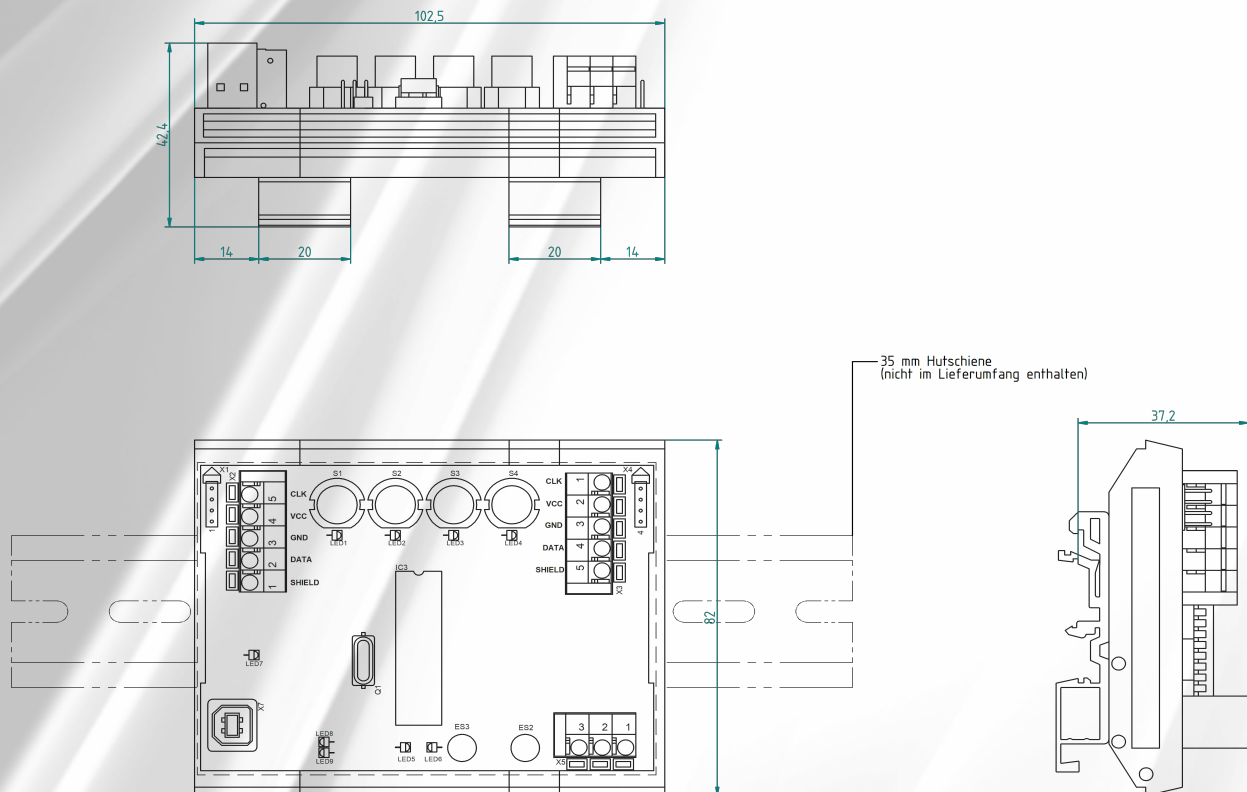

LISTEC GmbH
Am Sandberg 34
D - 84424 Isen
Germany

Tel.: +49 8083 5385-0
Fax.: +49 8083 5385-20
e-mail: info@listec-gmbh.de
www.listec-gmbh.de

A company of the Swiss Securitas Group
Subject to change without prior notice!